

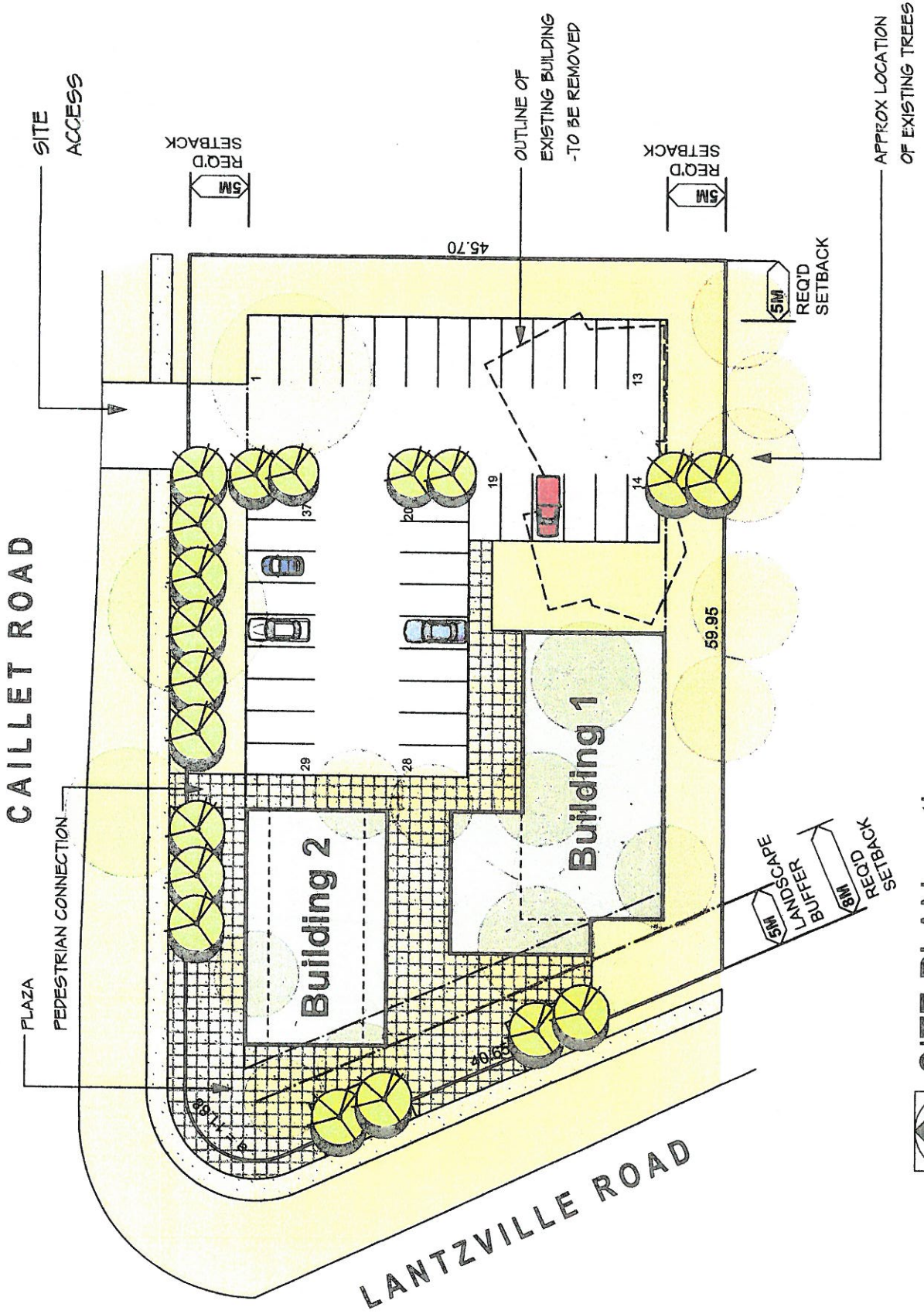

AERIAL
NOT TO SCALE

PROJECT DATA

CIVIC:	7143 CAILLET ROAD, LANTZVILLE	FLOOR AREA:	BUILDING 1
LEGAL:	LOT 2, DISTRICT LOT 27G (FORMERLY KNOWN AS DISTRICT LOT 27), WELLINGTON DISTRICT, PLAN 3633.		MAIN 4200 SQ.FT (390 SQ.M) UPPER 3200 SQ.FT (297 SQ.M) TOTAL 7400 SQ.FT (687 SQ.M)
LOT SIZE:	+/- 3,173 SQ.M		BUILDING 2 MAIN 2640 SQ.FT (245 SQ.M) UPPER 1760 SQ.FT (164 SQ.M) TOTAL 4400 SQ.FT (409 SQ.M)
ZONING:	CMI - COMMERCIAL I		TOTAL 11 800 SQ.FT (1096 SQ.M)
OCF LAND USE:	VILLAGE CORE		PARKING
LOT COVERAGE:	20% (MAX 40%)		OFFICE @ 1/30SQ.M
HEIGHT:	(MAX 9M)		1050/30 = 37 STALLS REQ'D
F.A.R.:	0.35 (MAX 0.4)		



SITE PLAN - option a
SCALE: 1:1000 METRIC

proposed development:

7143 CAILLET ROAD

lantzville b.c.

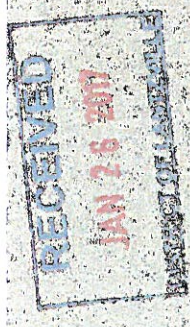

SITE PLAN PR1a

DESIGN CONSULTANTS LTD

d1016.13.07
to client

19 OCTOBER 2016